

The Drove
Taverham
OIEO £250,000



- Semi Detached House
- Entrance Hall
- Three Bedrooms
- Spacious Lounge
- Modern Kitchen/Diner

- Generous Enclosed Rear Garden
- Re-Fitted Family Bathroom Suite
- Garage & Ample Driveway
- Sought After Cul-De-Sac Position
- EPC Rating C

GROUND FLOOR
365 sq.ft. (33.9 sq.m.) approx.

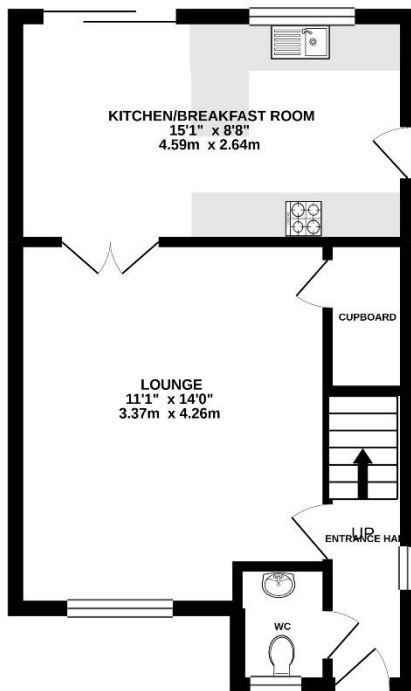

1ST FLOOR
345 sq.ft. (32.1 sq.m.) approx.

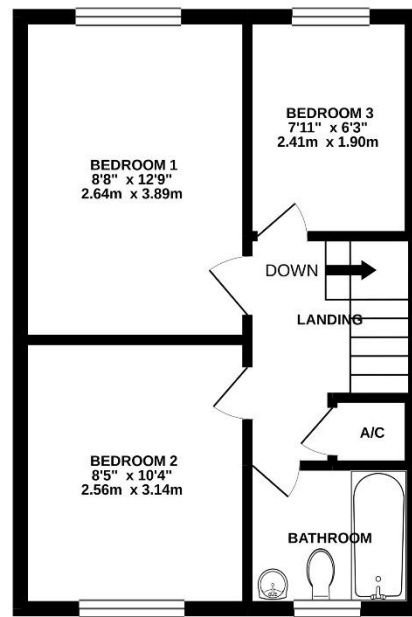

TOTAL FLOOR AREA : 710 sq.ft. (66.0 sq.m.) approx.

Whilst every attempt has been made to ensure the accuracy of the floorplan contained here, measurements of doors, windows, rooms and any other items are approximate and no responsibility is taken for any error, omission or mis-statement. This plan is for illustrative purposes only and should be used as such by any prospective purchaser. The services, systems and appliances shown here have not been tested and no guarantee as to their operability or efficiency can be given.
Made with Metropix ©2021

Leave Norwich on the Drayton Road and continue onto the Fakenham Road. Take the second entrance into Thorpe Marriott onto Kingswood Avenue. Take the right turn into The Cains which leads to The Drove, the property can be found on the left hand side.



Viewings strictly by appointment with: 297 Fakenham Road, Norwich, NR8 6LE

Taverham **01603 261104**
Norwich **01603 740044**

121 Park Lane, Mayfair, London W1K 7AG
020 7409 8450



We bring to prospective purchasers attention that we, as estate agents for the property, have not tested any appliances and purchasers should make their own enquiries of the relevant Authorities regarding the connection and viability of all services. These particulars, whilst believed to be accurate are set out as a general outline only for guidance and do not constitute any part of an offer or contract. Intending purchasers should not rely on them as statements of representation of fact, but must satisfy themselves by inspection or otherwise as to their accuracy.